

【Maintenance Notice】

1. Please read this manual carefully before use.
2. Free services can be provided with warranty card and invoice, welcome to contact us if you need technical support.
3. Customers can get 1 year warranty service from us with product related invoice and documents.
4. Please keep the warranty card properly so that the warranty can be obtained when the product needs repair.
5. The company is not responsible for the following repair services beyond the product, but we can still provide you with paid services.

- Products due to improper use or storage.
- Products without warranty card or other valid documents.
- Products due to unstable power supply voltage or beyond the normal voltage range or power supply and installation does not meet the electrical installation requirements.
- Promotional products.
- Products damaged caused by irresistible natural disasters.
- Products beyond maintenance period, damaged due to not follow the rules and methods of application.

【Technology Specification】

Model	PS-502	Power	4 W
Voltage	220 AC / 240V AC	Frequency	50/60Hz
Load	200 W	Weight	650 g
Size	152*90*55mm	Material	ABS

Warranty Card

(Please keep it properly)

Product Name		Product Number	
Purchase Time		Contact Number	
Customer information	Name/company		
	contact address		
Sales company stamp:			

Plasma Ions | 

Wind Pressure Switch

Model: PS-502



Please read the instructions before use

【Precautions】

There are electronic devices installed inside, do not open the case to avoid the risk of electric shock. Please read this [user manual] carefully before using the machine and follow the below points of operation base on the manual. Otherwise it may cause damage to product, or even cause injury to yourself or others at varying degrees.

- The wind pressure switch cannot be used in a humid environment, otherwise it will affect the use effect.
- To ensure the best performance of the machine, please do not cover the sensor of the wind pressure switch
- This machine is designed for only indoor general using. Do not place it open-air or high temperature place.
- Before operating the machine, make sure the power cord is firmly plugged into the power outlet, and place the power cord in a safe position. Do not touch, install or unplug the power cord with wet hands to avoid electric shock accidents.
- Before unplugging the power cord, please turn off the machine power in the correct procedure, otherwise it may cause damage to the machine.
- If don't use the machine for a long time, please unplug the power supply.
- The machine has precision components built inside. Don't open the case by yourself to avoid damage to the machine parts and may happen dangerous.

【Use and Characteristics】

- Shell is ABS flame retardant materiall.
- The wind pressure switch can be used continuously for a long time. It is recommended to clean the wind pressure sensor once about 12 months to avoid affecting the use effect.
- PS-502 wind pressure switch is an intelligent and highly sensitive automatic control system. It can automatically control the opening and closing of the plasma air disinfection and purification system: when a certain amount of wind blows through the wind pressure sensor, the plasma tube equipment will automatically start to work. If there is no wind or the air volume is not enough, the plasma equipment will automatically stop working.

【Instructions】

- 1 Connect the power cord of the input end to the socket, turn on the power, and the green indicator light is on.
- 2 Connect the output port to the power port of the plasma equipment, and the red light will turn on, indicating that the plasma equipment is working. The red light is off, indicating that the plasma equipment has stopped working
- 3 The adjustment method and precautions of the induction sensitivity of the wind pressureswitch:
 - Sensitivity is preset at the factory, and can be adjusted according to actual conditions in actual use.
 - First use a screwdriver to open the four screws on the cover.
 - Turn the screw clockwise with a screwdriver to lower the sensitivity, and the plasma equipment will not be frequently turned on and off due to subtle changes in wind pressure.
 - Turn the screw counterclockwise with a screwdriver to increase the sensitivity, and the plasma equipment will be frequently turned on and off due to subtle changes in wind pressure.

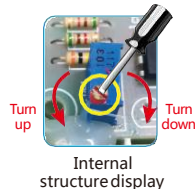

【Fault Check】

Fault condition	Processing check
The green indicator light does not light up	Check whether the power cord plug is firmly inserted into the socket and whether it is loose, and check whether the power socket has electricity.
The red indicator light is always off	Check whether the wind pressure sensor is blocked by foreign objects, or remove the cover to adjust the sensitivity of the wind pressure sensor.

Please send the following to the company's designated maintenance department for repairs.

1. The problem cannot be solved as described above.
2. Foreign matter or moisture enters, and abnormal conditions occur.

【Constituent unit】

(1) Product overview:

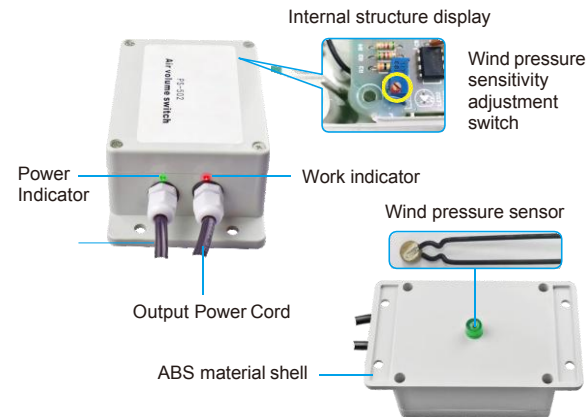

(2) Product Size:

